

**OFFICIAL**

**GLASGOW CITY COUNCIL**

**EDUCATION SERVICES**

**THIS IS A CONSULTATIVE  
DOCUMENT**

**Proposal: to relocate Govanhill Nursery and Cuthbertson Nursery class into the new nursery in the grounds of Cuthbertson Primary School which will be open all year and provide early learning and childcare for children from age two to five years.**

<b>Schools</b>	<b>Ward(s)</b>	<b>Strategic Planning Area</b>	<b>Learning Communities</b>
Govanhill Nursery	8	S	Holyrood
Cuthbertson Nursery Class	8	S	Shawlands
New nursery Cuthbertson	8	S	Shawlands

***REPORT BY EXECUTIVE DIRECTOR OF EDUCATION***

The Ordnance Survey map data included within this document is provided by Glasgow City Council under licence from Ordnance Survey in order to fulfil its public function in relation to this public consultation. Persons viewing this mapping should contact Ordnance Survey Copyright for advice where they wish to licence Ordnance Survey mapping/data for their own use.

**OFFICIAL**

## OFFICIAL

### 1. Background and Context

- 1.1 In 2017, the Scottish Government published the '*Blueprint for 2020*', outlining proposals to deliver on the previously announced policy commitment to increase the statutory entitlement for early learning and childcare (ELC) from 600 to 1140 hours by August 2020. The *Blueprint* sets out requirements for local authorities to seek to deliver a service which prioritised quality, affordability, accessibility and flexibility.
- 1.2. In September 2017, Glasgow City Council submitted detailed plans to the Scottish Government, setting out proposals to deliver 1140 hours of statutory hours by August 2020. Our vision focusses on delivering the requirements set out in the *Blueprint*, with ELC settings moving to becoming all day, all year services, maximising choice and flexibility for parents and making better use of our resources and estate.
- 1.3. The Scottish Government confirmed on the 1<sup>st</sup> May 2018 that a capital award totalling £44.130m would be provided to undertake estate related projects in line with the expansion plans. The offer of £44.130m was predicated on being used for specific works associated with the expansion plans. It does not make financial provision for investment outwith the scope of funded eligibility i.e. 3 and 4 year olds and eligible two year olds.
- 1.4 Since the Scottish Government first announced the expansion programme, significant work has been undertaken to prepare information and develop Glasgow's response to the expansion plans across a wide range of workstreams, encompassing workforce, quality, communications, and partnership delivery. Property has been one of those key workstreams. Detailed analysis of ELC provision has been undertaken across the city, comparing demand (number of children and families) to supply (statutory places across all providers), to ensure that capital is allocated where most required. This exercise has identified specific communities across the city, requiring additional physical capacity to deliver the increase in statutory hours.
- 1.5 A paper on capital plans was taken to the City Administration Committee on 30<sup>th</sup> August 2018. In line with the recommendations from the paper. A non-statutory consultation took place during November to seek the views of stakeholders on a range of proposals to extend early learning and childcare across the city. The response to the consultation is available on <https://glasgow.gov.uk/index.aspx?articleid=17886>
- 1.6 The above consultation advised of the proposal to locate a new nursery in the grounds of Cuthbertson Primary School.

### 2 Local Nurseries

- 2.1 Govanhill Nursery is open all year from 8.00 am to 6.00 pm. It provides high quality early learning and childcare for 80 full-time equivalent places for 3 to 5 year olds.

OFFICIAL

## OFFICIAL

- 3.3 Cuthbertson Nursery Class is open term-time from 8.30 am to 4.30 pm. It provides high quality early learning and childcare and has 40 full-time equivalent places for 3 to 5 year olds.
- 3.4 The building at Govanhill Nursery is single storey of traditional construction with facing brick finish, flat roof and uPVC double glazing. Internally it has open plan style play rooms and toilets off the playrooms. Externally there is a tarmac play area with a small area of soft landscaping and a few mature trees. It would benefit from some modernisation and there is room on the site to create some modest extensions if required. It is registered presently for 80 3 to 5 year olds.
- 3.5 Appendix 1 shows the position of each of the nurseries.
- 3.6 Appendix 2 shows the design of the proposed nursery.

## **4 Proposal**

- 4.1 It is proposed to relocate the two nurseries into the new nursery being built on in the grounds of Cuthbertson Primary School. The new nursery would provide high quality early learning and childcare and would have 87 full-time equivalent places for 2 to 5 year olds.
- 4.2 The building at Govanhill Nursery School would be made available to other providers of early learning and childcare through the Council's flexible renting policy. The area which the nursery class currently uses will be given to the school. Adaptations will be made, as necessary. There will also be improvements made to the outdoor playing area of the primary school.
- 4.3 This is a significant increase in the number of places available and with extended hours which would give parents more flexibility.
- 4.3 A staffing structure would be put in place for the new nursery, which would take into account the requirements of the Care Inspectorate. The staff of Govanhill and Cuthbertson nursery class would be offered to relocate to the new nursery. All staff would continue to be employed by Education Services. Those staff who did not want to transfer to the new nursery would be offered suitable vacancies in other nurseries as available at that time. Discussions would take place with individuals and their trade unions to ensure that their individual needs and wishes are taken into consideration as much as possible. The staffing structure would include a mixture of staff on term-time and all year contracts.
- 4.4 The new nursery would be part of the Shawlands Learning Community.

## **5. Roll Projection Methodology**

- 5.1 Planning for the demand for nursery places is reviewed annually. Future demand is predicted taking into account the following factors:

## OFFICIAL

## OFFICIAL

- Birth rates in Glasgow.
- Housing needs assessment, contained in strategic and local plans.
- Migration of children in and out of Glasgow.
- The historical demand for placements made by parents resident in other Local Authorities.

5.2 Early Years' establishments have fixed rolls and capacities agreed in partnership with the Care Inspectorate. Should the proposal be agreed, children who attend Govanhill Nursery and Cuthbertson nursery class would be offered a continued placement at the new nursery or an alternative nursery based on parental choice. The new nursery would have increased capacity to meet the anticipated demand for placements. In addition, it would offer new provision for younger children. Admissions would continue to be managed within the existing policy and procedures.

5.3 The consultation will include seeking ideas for a new name for the nursery. There will be a further consultation with parents of the new nursery to finalise the name.

## **6. Educational Benefit Statement For The Proposal**

### **6.1 The Children**

6.1.1 Currently, both nurseries provide high quality early years education and childcare. They provide valued support to parents and carers. The development of the new nursery will continue this high standard of provision. The new nursery would provide high quality playrooms. This would provide a quality learning environment and support children's learning within Curriculum for Excellence at the early level. In addition, toilet and changing facilities would be improved to a level that would exceed legislative requirements and meet the needs of all the children including those with additional support needs.

6.1.2 The new building would highlight the value that the Council places on the importance of a high quality-learning environment, particularly for our most vulnerable children. The nursery would include a dedicated parents' room to allow the nursery provide family support in line with the Council's policy on early intervention.

6.1.3 The grounds around the nursery would be designed to provide high quality playground and outdoor space. This would provide better opportunities for children to play and learn. The appendices provide an indication of how the nursery will look with its grounds landscaped.

### **6.2 Parents, Carers and Local Community**

6.2.1 The new nursery would increase the number of nursery places available for parents all year round. The new nursery would provide a focus for the community engagement and further develop existing community links.

## OFFICIAL

## OFFICIAL

- 6.2.2 It is proposed that the nursery would be open throughout the year from 8.00 am to 6.00 pm. This would offer families, particularly working parents, childcare and education throughout the year. This is in line with the national and Council priority to support working families and the economy.
- 6.2.3 The development of the nursery would extend access to services and nursery places available to vulnerable two year olds and their families.
- 6.2.4 The nursery would have facilities, which would allow parents to become involved in the life and work of the centre. A parents' room would be created and families encouraged to work with staff and other partners to better understand a range of issues such as child development, parenting, budgeting as well as offer opportunities for continued adult education. The development of parents' room and visiting professionals' accommodation in the new nursery would significantly improve opportunities for partnership work.
- 6.2.5 It is important that parents and carers are secure in the knowledge that their families and children's needs are understood and met. Education staff in the new nursery would build on the already existing good practice in both nurseries and work in collaboration with a wide range of professional partners.

### **6.3 Other users**

- 6.3.1 The new nursery would have improved facilities. There are currently no other users of the two existing nurseries. The nature of the layout of nurseries make it generally unsuitable for other users to let in the evenings.

### **6.4 Future users of the provision**

- 6.4.1 The changes proposed would improve the facilities in the area. There would be no detriment to future users of the provision.

### **6.5 Other schools/establishments in our authority**

- 6.5.1 The proposal would not impact adversely on other schools or establishments. The new nursery would expand the number of early years' places available in the south of the city and would reduce demand for placement at other establishments in the area.

### **6.6 Our assessment of any other likely effects of the proposal (if implemented)**

- 6.6.1 The proposal would increase the number of available early years' places in the south of the city. With two staff teams coming together there will be increased opportunities for sharing of good practice. A larger staff allows for further sharing of best practice and more opportunities for curriculum development.

## OFFICIAL

## OFFICIAL

### **6.7 How we would intend to minimise or avoid any adverse affects that may arise from the proposal (if implemented)**

- 6.7.1 Education Services has a duty to secure improvement in education. Through our quality assurance and improvement policy, Education Services monitors and supports the quality of education being delivered in all its establishments. This policy would be used to monitor and support the quality of education and care being delivered in the new establishment to ensure that provision for children continues to develop and improve. Leaders of Early Learning, Quality Improvement Officers would provide support prior to, during and after the development of the new nursery to ensure continuity of learning.

### **6.8 The benefits, which we believe, would result from implementation of this proposal**

- 6.8.1 In addition to the benefits detailed above, this proposal would support the desire that schools and communities have access to high quality resources.

## **7. Equality Statement**

- 7.1 An Equality Impact assessment will be undertaken as part of the consultation exercise to assess if the proposal discriminates against anyone on the basis of:

- Age
- Gender
- Religion
- Racial Group
- Disability
- Sexual Orientation

In carrying out the equality impact assessment we will take account of (and address) any equality issues raised in written or oral representation made as part of the consultation process. The result of the equality impact assessment will be included in the consultation response document and will also be available on the Glasgow City Council website.

## **8. Proposed Date For Implementation Of The Proposal**

- 8.1 It is intended that, if agreed, the proposal would be progressed before the end of 2021. The final date will depend on the progress of the building works.

## **9. The Consultation Process**

- 9.1 We will engage with parents and carers linked to the two nurseries, the local primary schools, elected members and the local community council.
- 9.2 Consultation papers have been distributed to a wide range of stakeholders and interested parties. The paper will also be placed on the web-site

OFFICIAL

## OFFICIAL

**Web site address:** [www.glasgow.gov.uk/schoolconsultations](http://www.glasgow.gov.uk/schoolconsultations)

**e-mail address:** [Schoolconsultations@glasgow.gov.uk](mailto:Schoolconsultations@glasgow.gov.uk)

The indicative timetable for the consultations is as per the table below

Date	Action	
16 December 2020 – 18 February 2021	On-line with consultation with stakeholders	Through survey monkey. Summary letter to be issued to all stakeholders: <ul style="list-style-type: none"><li>- Cuthbertson PS</li><li>- Govanhill Nursery</li><li>- St Bride's PS</li><li>- Govanhill CC</li><li>- Govanhill Regeneration Group</li><li>- Local elected members, including MSPs and MP</li><li>- Professional associations</li></ul>

OFFICIAL







# Appendix 1

## Cuthbertson Primary School & Nursery Class Govanhill Nursery School & Proposed Site of New Nursery School

Cuthbertson Primary School & Nursery Class

Govanhill Nursery School

Proposed New Nursery School Site

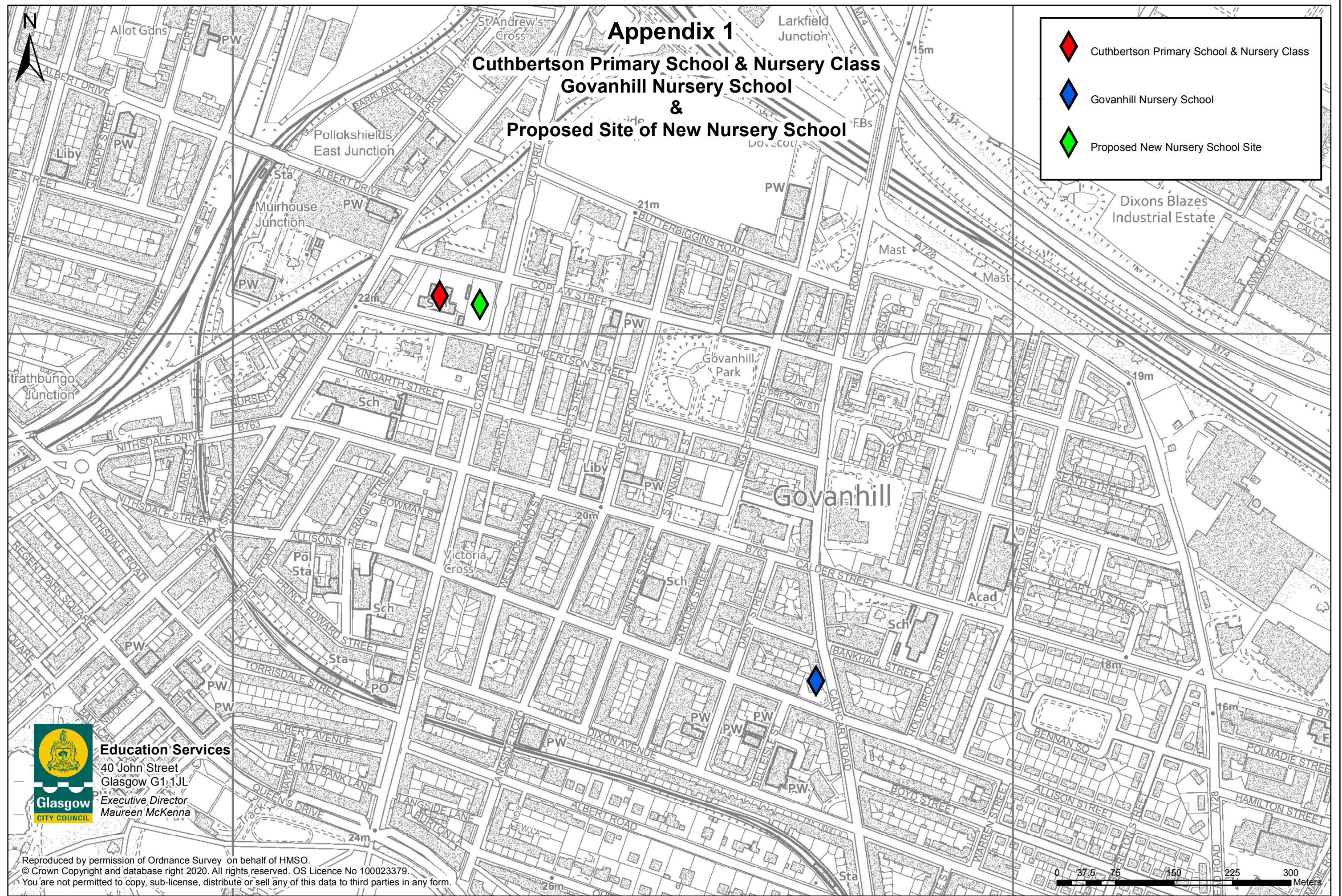

**Education Services**  
40 John Street  
Glasgow G1 1JL  
Executive Director  
Maureen McKenna

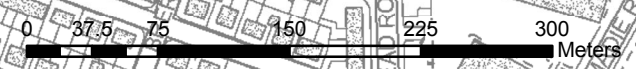



APPENDIX 2

REV	DESCRIPTION	DATE	BY



DRAWING STATUS  
**PLANNING**



**Glasgow City Council**  
Development & Regeneration Services  
*Project Management & Design*  
231 George Street, Glasgow, G1 1RX  
www.glasgow.gov.uk  
Tel: 0141 287 8555 Fax: 0141 287 8444  
Executive Director: Richard Brown

JOB  
**NEW EARLY LEARNING & CHILDCARE FACILITY AT GOVANHILL**

TITLE  
**3D Visualisation**  
**View towards the main entrance from Victoria Road**

SCALE at A3 <b>NTS</b>	DATE <b>2020/01/09</b>	DRAWN <b>GP</b>
JOB NO. <b>ED416001</b>	APPROVED <b>JL</b>	
DRG NO. <b>A-VS(01)XX-001-PL</b>	REVISION <b>-</b>	

CAD FILE: ...ED416001-A-VS(01)XX-001-PL\_3D Visualisation.dgn  
PLOTTED BY \$ ON 31/01/2020 AT 19:00:29

DO NOT SCALE: WORK TO FIGURED DIMENSIONS ONLY  
DRS\_A3\_TTT-MM March 2009



REV	DESCRIPTION	DATE	BY



DRAWING STATUS

# PLANNING



**Glasgow City Council**  
Development & Regeneration Services  
*Project Management & Design*  
231 George Street, Glasgow, G1 1RX  
[www.glasgow.gov.uk](http://www.glasgow.gov.uk)  
Tel: 0141 287 8555 Fax: 0141 287 8444  
Executive Director: Richard Brown

JOB  
**NEW EARLY LEARNING &  
CHILDCARE FACILITY AT  
GOVANHILL**

TITLE  
**3D Visualisation  
View from the External Playspace**

SCALE at A3 <b>NTS</b>	DATE <b>2020/01/09</b>	DRAWN <b>GP</b>
JOB NO. <b>ED416001</b>	APPROVED <b>JL</b>	
DRG NO. <b>A-VS(01)XX-002-PL</b>	REVISION <b>-</b>	

CAD FILE: ...ED416001-A-VS(01)XX-002-PL\_3D Visualisation.dgn  
PLOTTED BY: ON 31/01/2020 AT 13:36:40

DO NOT SCALE: WORK TO FIGURED DIMENSIONS ONLY  
DRS\_A3\_TTT - MM March 2009



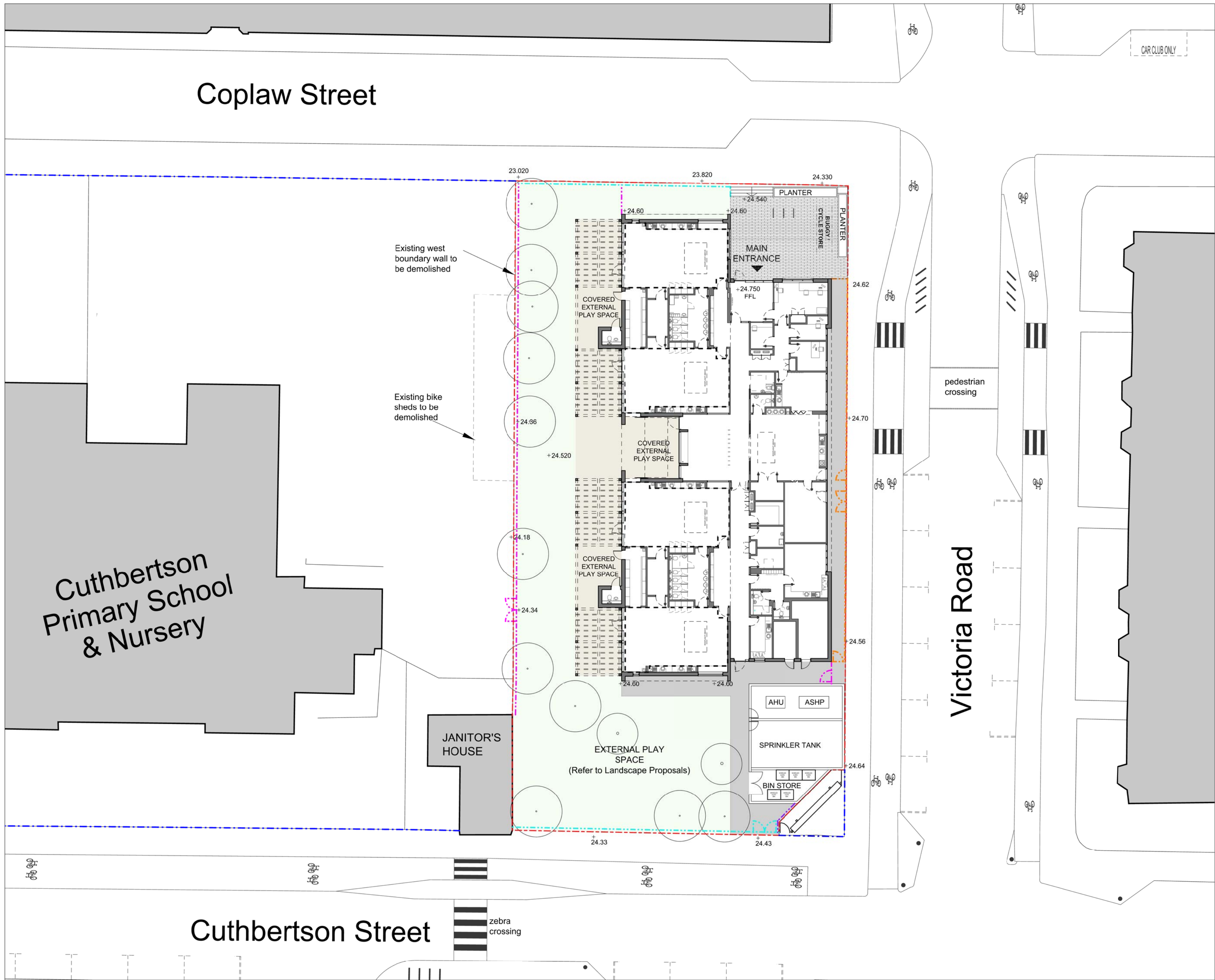

SITE PLAN AS PROPOSED  
SCALE - 1:250



REV	DESCRIPTION	DATE	BY

NEW TREES

PAVING

BITMAC SURFACE

SOFT LANDSCAPING, REFER TO LANDSCAPE PROPOSALS

COVERED/ SEMI COVERED EXTERNAL PLAY SPACE - HARD LANDSCAPING

1.8M HIGH WELDMESH FENCE ABOVE EDGING/ KERB, COLOUR GALVANISED, COLOUR TBC

1.3M HIGH METAL RAILING FENCE WITH DECORATIVE LASER CUT METAL INFILL PANELS & GATES (COLOUR GALVANISED, COLOUR TBC)

1.8M HIGH METAL RAILING FENCE & GATES (COLOUR GALVANISED, COLOUR TBC) ON TOP OF APPROX. 450mm HIGH BRICK BASE WITH BRICK PIERS AND PRECAST CONCRETE COPIES

1.8M HIGH METAL RAILING FENCE & GATES (COLOUR GALVANISED, COLOUR TBC)

NB: Cycle lanes & alterations to the carriageway & footways along Cuthbertson Street & Victoria Road as shown, is currently under construction by others as part of GCC's South City Way.



SITE BOUNDARY LINE

ADJACENT LAND IN GCC OWNERSHIP

USE FIGURED DIMENSIONS ONLY. DO NOT SCALE FROM THIS DRAWING. ALL DIMENSIONS IN MM UNLESS NOTED OTHERWISE.

ALL DIMENSIONS TO BE VERIFIED ON SITE BEFORE PROCEEDING WITH WORK.

GCC DRB PROJECT MANAGEMENT AND DESIGN (PM&D) TO BE NOTIFIED IN WRITING OF ANY DISCREPANCIES PRIOR TO ORDERING MATERIALS OR COMMENCING WORK.

TO BE READ IN CONJUNCTION WITH ALL OTHER PM&D DRAWINGS, SCHEDULES AND SPECIFICATIONS.

ALL DRAWINGS TO BE READ IN CONJUNCTION WITH ENGINEER'S DRAWINGS.

REFER TO CONSULTANTS' DRAWINGS FOR STRUCTURAL AND SERVICES INFORMATION.

DRAWING STATUS

PLANNING



Glasgow City Council  
Development & Regeneration Services

Project Management & Design

231 George Street, Glasgow, G1 1RX  
www.glasgow.gov.uk

Tel : 0141 287 8555 Fax : 0141 287 8444

Executive Director : Richard Brown

JOB

NEW EARLY LEARNING &  
CHILD CARE FACILITY AT  
GOVANHILL

TITLE

Site Plan as Proposed

SCALE at A2

1:250

DATE

2019/11/08

DRAWN

YP

JOB NO.

ED416001

APPROVED

JL

DRG NO.

A-DR(01)ST-100-PL

REVISION

CAD FILE ...ED416001-A-DR(01)ST-100-PL Site Plan as Proposed (Cuthbertson).dgn

PLOTTED BY ON 31/01/2020 AT 12:22:23

DO NOT SCALE : WORK TO FIGURED DIMENSIONS ONLY