

Section A - A

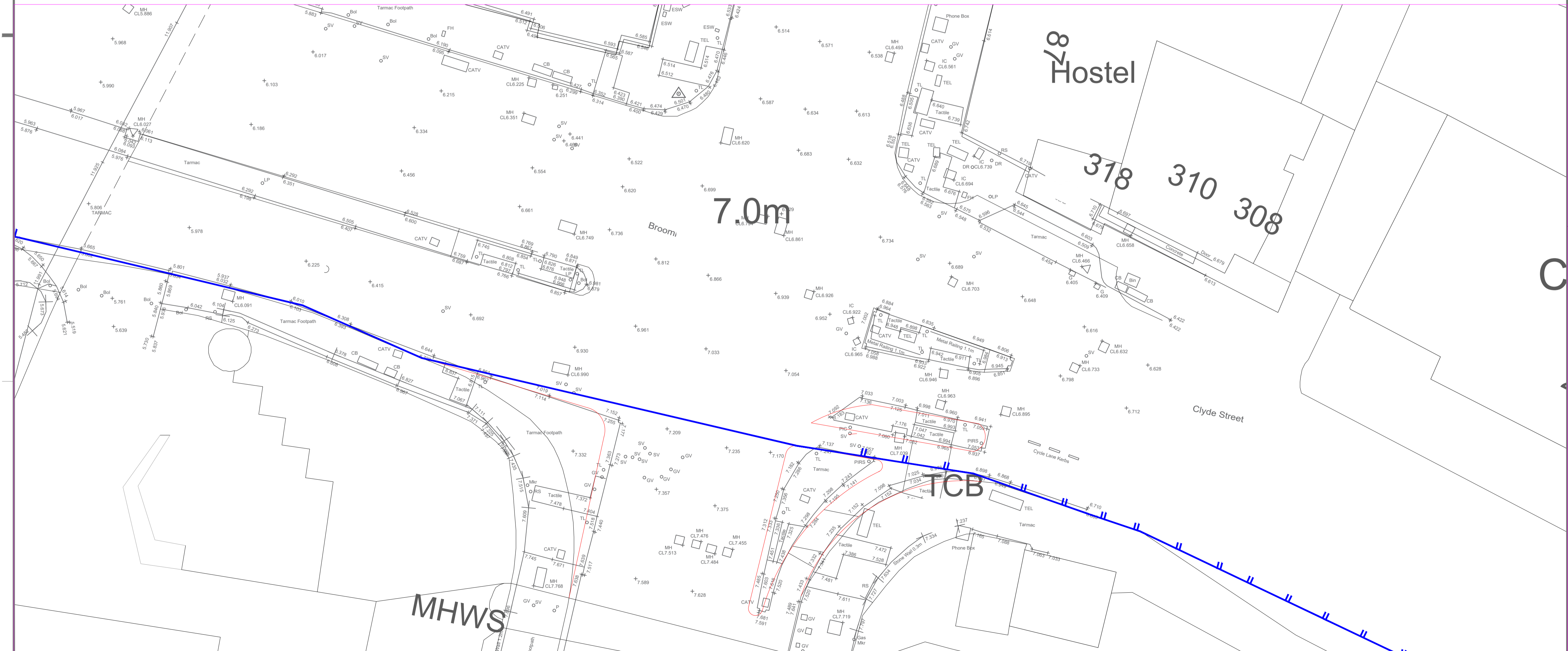

Section B - B

NOTES:

Legend

Proposed Bi-Directional Cycle Facility

© Crown copyright and database rights 2024. OS Licence Number AC000849454.
You are permitted to use this data solely to enable you to respond to, or interact with, the organisation that provided you with the data. You are not permitted to copy, sub-licence or sell any of this data to third parties in any form.

Rev	Date	Revisions	Checked by	Approved by

Glasgow City Council

Prepared by : OA Date : 19/09/2024

Checked by : DC Scale : 1:500

Approved by : Software : AutoCAD 2019

Executive Director of Neighbourhoods, Regeneration and Sustainability:

George Gillespie BEng (Hons) CEng MICE

Design Office:

Exchange House, 231 George Street, Glasgow, G1 1RX

KING GEORGE V BRIDGE

JUNCTION IMPROVEMENTS

TRO Drawing

Drawing No:

32_5354_07

File Location:

Client:

Original Drawing Size: 841*594 (A1)

U:\PMD\PLINGIP-5354_George V Bridge_Junction Improvements\DRAWINGS\01 Preliminary\om\King George V Bridge\AutoCAD Drawing\32_5354_01_GVB2.0.dwg