

Inserting and removing the SIM card – iPhone 7

1. Ensure the device is powered off.

2. From the right edge of the device, remove the SIM card tray.

→ Use the SIM eject tool found in your iPhone box (or use a paperclip) to unlock the tray by inserting it into the provided slot.

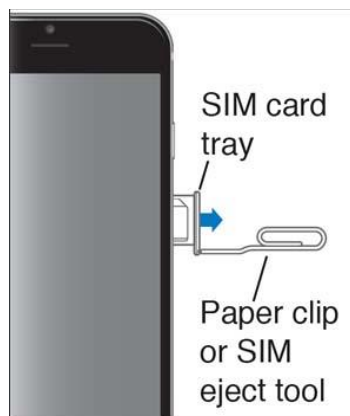

3. Insert the SIM card into the SIM card tray.



4. Press in on the tray to lock it into place.

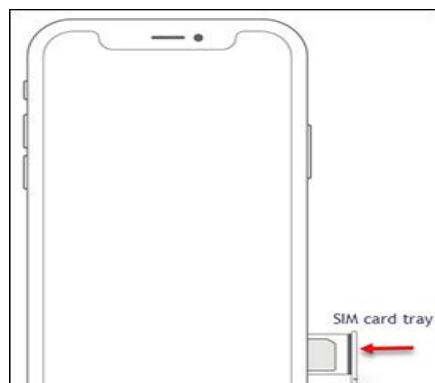

You've completed the steps!